

4

3

2

1

D

D

C

C

B

B

A

A

CHARGING HANDLE

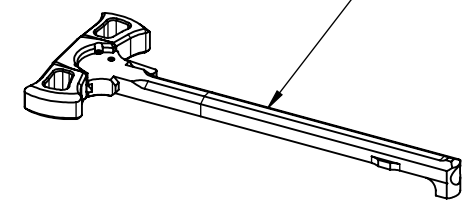

QD LOCKING LUG SCREW

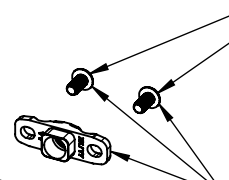

QD LOCKING LUG KIT

RENEGADE HANDGUARD
14.5" NON WINDOW

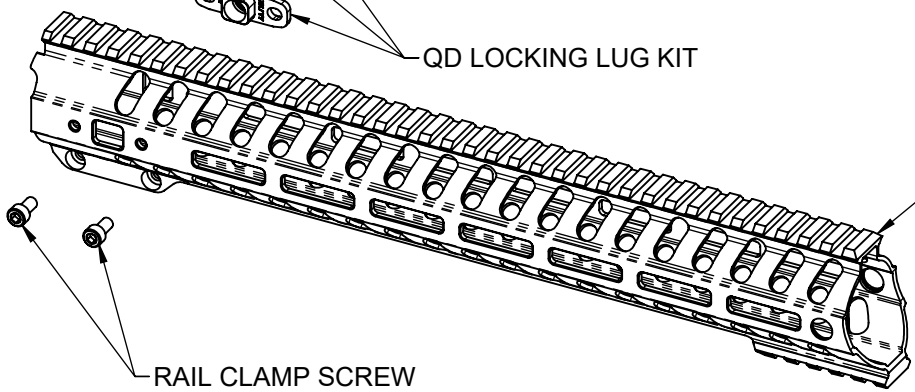

RAIL CLAMP SCREW

FIRING PIN
RETAINING PIN

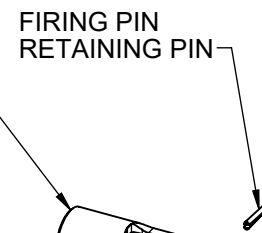

ROLLER CAM PIN



BOLT CARRIER

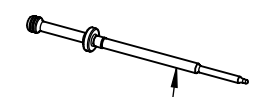

FIRING PIN

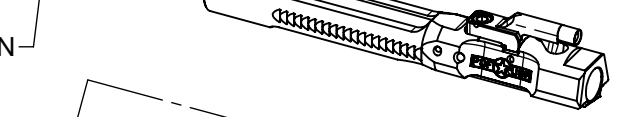

FORWARD ASSIST
SPRING



FORWARD ASSIST
RETAINING PIN

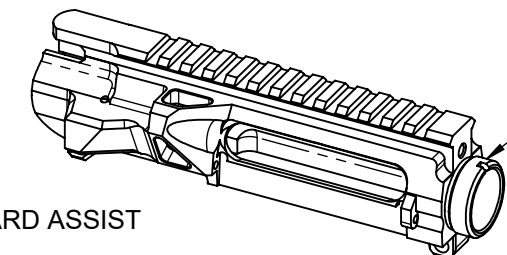

UPPER RECEIVER

EJECTOR ROLL PIN



FORWARD ASSIST



BOLT

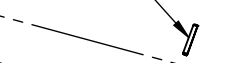

EJECTOR



EXTRACTOR PIN

EXTRACTOR SPRING

EXTRACTOR

EJECTOR SPRING



EXTRACTOR KIT

EJECTION PORT
COVER SPRING

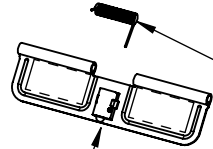

EJECTION PORT COVER ROD

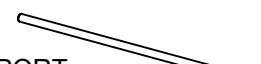

EJECTION PORT C CLIP



EJECTION PORT
COVER ASSY

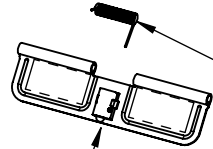

RIFLE LENGTH
DICTATOR GAS BLOCK KIT

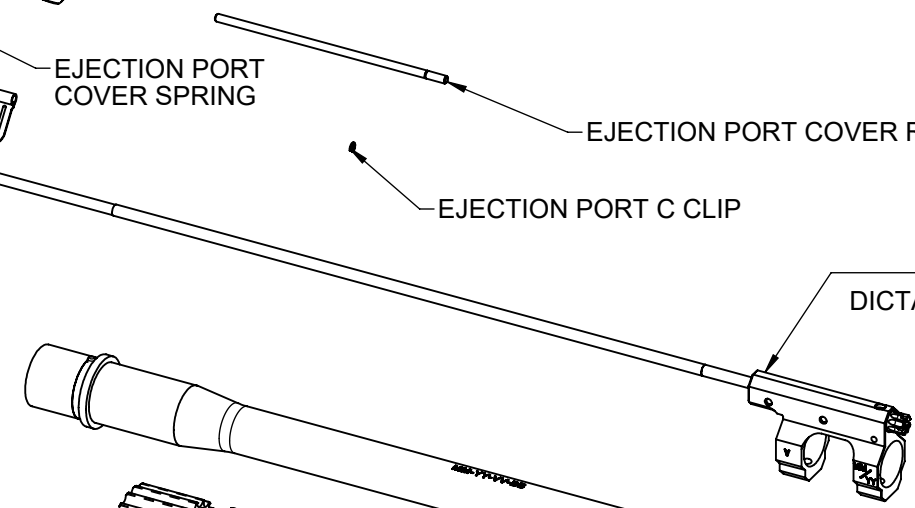

HEAT SINK
BARREL NUT

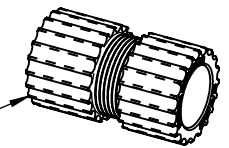

LOCK NUT



GAS BLOCK SET SCREWS



MUZZLE BRAKE

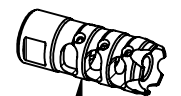

POF-USA CMR DI UPPER RECEIVER COMPONENTS BY PART DESCRIPTION

REV DATE: 10/16/2020

4

3

2

1

4

3

2

1

D

D

C

C

B

B

A

A

COMPLETE ASSY
 00849 (TOMAHAWK) SHOWN
 00782 (RATTLER)
 00813 (ARCHANGEL)
 01542 (STRIKE EAGLE)

01011

01010 KIT

01034

00954

00307

01632

00940

01492

00886

00930

00952

01493

00929

00949

**01410
EXTRACTOR KIT**

0927

00925

00926

00567

00839

00915

00309

POF-USA CMR DI UPPER RECEIVER COMPONENTS BY SKU NUMBER

REV DATE: 10/16/2020

4

3

2

1